

WEATHER SENSORS:

The following sensor can be mounted on the weather station structure code 303002015 (max.5 sensors) or on the single sensor support code 303002021 (max.1 sensor).

Every sensor is supplied with an S-BUS interface board. The board must be installed in to the support structure (303002015 or 303002021).

	Code		Signal type	
			S-BUS	Contact
	303002001	<p>Solar radiation sensor. Radiation intensity range: 0 ÷ 2000 w/m² Spectrum range: 400-950 nm Supplied with:</p> <ul style="list-style-type: none"> • 4 m cable (4x 0.5 mm²). • S-BUS interface board • Mounting screws kit 	✓	
	303002011	<p>Wind speed sensor. Wind speed range: 0.2 ÷ 60 m/s Supplied with:</p> <ul style="list-style-type: none"> • 7 m cable (2x 0.22 mm²). • S-BUS interface board • Mounting screws kit 	✓	
	303002012	<p>Wind direction sensor. Measuring range 0 ÷ 359 ° (1° resolution) Supplied with:</p> <ul style="list-style-type: none"> • 7 m cable (3x 0.22 mm²). • S-BUS interface board • Mounting screws kit 	✓	
	303002013	<p>Rain presence sensor. Infrared measuring principle. Supplied with:</p> <ul style="list-style-type: none"> • 7 m cable (4x 0.5 mm²). • S-BUS interface board • Mounting screws kit 	✓	
	303002014	<p>Electronic temperature and humidity sensor with environmental protection. Temperature range: -20°C ÷ +50°C (-4°F ÷ 122°F) Humidity range: 10% ÷ 98% Supplied with:</p> <ul style="list-style-type: none"> • 4 m cable (4x 0.22 mm²). • S-BUS interface board • Mounting screws kit 	✓	

SENSORS



303002006

Weather station with the following sensors:

- Rain presence sensor. ✓ x 3
- Wind speed sensor.
- Solar radiation sensor.



303002018

Weather station with the following sensors:

- Rain presence sensor. ✓ x 4
- Wind speed sensor.
- Wind direction sensor.
- Solar radiation sensor.

SINGLE METEO SENSOR SUPPORT SYSTEM:



Code



30300200

Support for 1 meteo sensor composed by:
 • Stainless steel sensor fixing bracket, suitable for mounting on Ø 32mm pole (pole code 303002019)

Sensor support

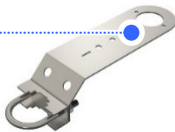

Sensor's interface board



30300201

Support for 1 meteo sensor composed by:
 • Stainless steel sensor fixing bracket, suitable for mounting on Ø 32mm pole (pole code 303002019)
 • Plastic box for the containment of the sensor S-BUS interface board.



30300209

Stainless steel Support pole for weather sensor bracket (bracket code 303002020 and 303002021)